

## INDUSTRIAL PLATFORMS



**Alapont industrial platforms** are designed to raise loads of from 150 kg to 3 000 kg on a single column, and from 3 000 kg to 5 000 kg on 2 columns, for a wide range of dimensions, routes and stops. Furthermore, some models incorporate an inverted chassis that allows the platform, along with its guides, to be installed level with the top floor.

All apparatus are manufactured under European directive 98/371/EC and applicable national regulations.

## One-column platform

### General characteristics:

- Manufacture of routes and surfaces on demand.
- Ideal for loads from 150 kg to 3 000 kg.
- Maximum route: 12 m
- Non-slip sheeting.
- Automatic re-levelling (optional)
- Control of loosening or broken cables. Hydraulic non-return.
- Nominal speed: 0.1 m/s (optional 0.2 m/s).
- End-of-route safety timer.
- Exterior surface buttons with STOP button.
- Manual doors of one or two panels (optional)

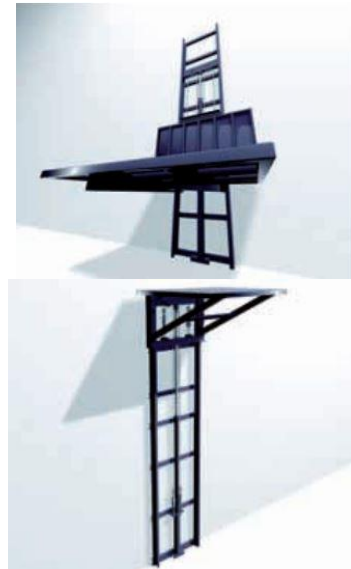

| Carga (Kgs) | (I) Ancho (mm) |       | (G) Fondo (mm) |       | A (mm) |           |         | F (mm) | L (mm) | Huída (Min) | Reacc. (Kgs) |
|-------------|----------------|-------|----------------|-------|--------|-----------|---------|--------|--------|-------------|--------------|
|             | Max            | Min   | Max            | Min   | PRH-1  | PRH-1 (2) | PRH-1-I |        |        |             |              |
| 150         | 1.200          | 550   | 900            | 500   | 100    | /         | 750     | 120    | 430    | 1.340       | 1.000        |
| 300         | 1.500          | 750   | 1.300          | 600   | 210    | /         | 750     | 155    | 610    | 1.500       | 1.400        |
| 400         | 1.500          | 750   | 1.300          | 600   | 210    | /         | 750     | 155    | 610    | 1.500       | 1.600        |
| 500         | 2.000          | 950   | 1.300          | 600   | 210    | 450       | 900     | 155    | 805    | 1.560       | 1.800        |
| 750         | 2.500          | 950   | 1.500          | 800   | 210    | 550       | 1.000   | 180    | 805    | 1.560       | 2.200        |
| 1.000       | 2.700          | 1.150 | 2.000          | 800   | 250    | 550       | 1.000   | 205    | 1.000  | 1.800       | 2.800        |
| 1.500       | 3.000          | 1.150 | 2.000          | 800   | 270    | 650       | 1.250   | 230    | 1.000  | 1.980       | 3.400        |
| 2.000       | 3.500          | 1.650 | 2.000          | 1.000 | 280    | 650       | 1.500   | 230    | 1.000  | 2.000       | 4.200        |
| 3.000       | 3.200          | 1.650 | 2.000          | 1.000 | /      | 650       | 1.500   | 255    | 1.500  | 2.000       | 5.900        |

PRH-1

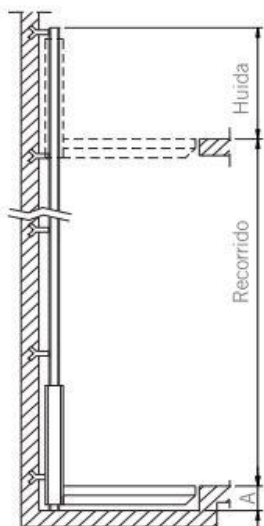

PRH-1 (2)

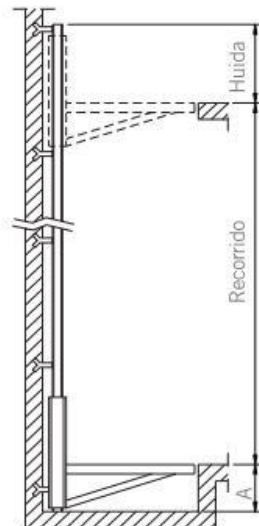

PRH-1-I

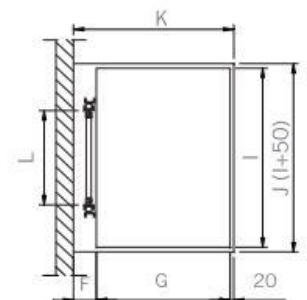
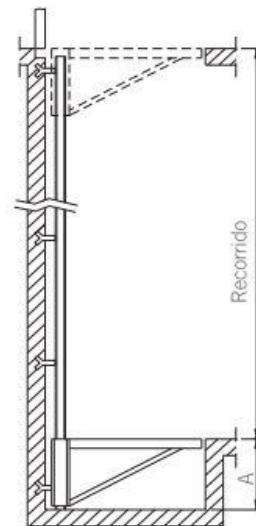

## Two-column platform

### General characteristics:

- Manufacture of routes and surfaces on demand.
- Ideal for loads from 150 kg to 3 000 kg.
- Maximum route: 12 m
- Non-slip sheeting.
- Automatic re-levelling (optional)
- Control of loosening or broken cables. Hydraulic non-return.
- Nominal speed: 0.1 m/s (optional 0.2 m/s).
- End-of-route safety timer.
- Exterior surface buttons with STOP button.
- Manual doors of one or two panels (optional)



| Carga<br>(Kgs) | (G) Ancho<br>(mm) | (I) Fondo<br>(mm) | A (mm) |         | F<br>(mm) | Huída<br>Mín. | Reacc.<br>(Kgs) |
|----------------|-------------------|-------------------|--------|---------|-----------|---------------|-----------------|
|                |                   |                   | PRH-2  | PRH-2-I |           |               |                 |
| 1.500          | 2.000             | 3.000             | 550    | 1.600   | 180       | 1.700         | 3.000           |
| 2.000          | 2.500             | 5.000             | 550    | 1.600   | 205       | 1.700         | 3.700           |
| 3.000          | 2.500             | 5.000             | 600    | 1.800   | 230       | 2.060         | 4.500           |
| 4.000          | 2.500             | 5.000             | 650    | 2.300   | 255       | 2.060         | 5.400           |
| 5.000          | 2.500             | 5.000             | 650    | 2.300   | 280       | 2.060         | 6.400           |

PRH-2

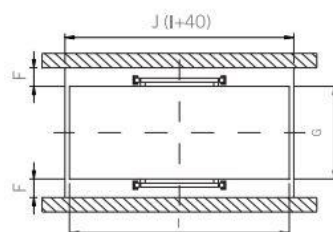
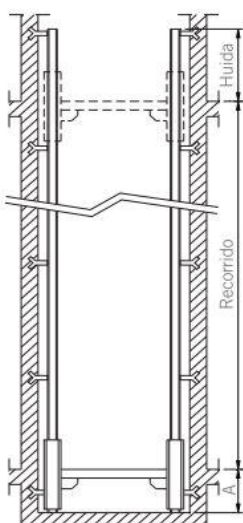

PRH-2-I

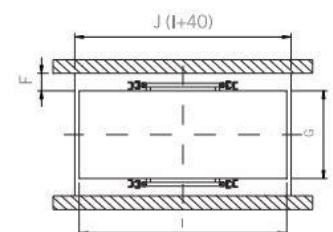
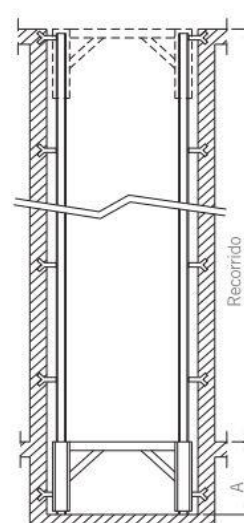



[Alapontlogistics.com](http://Alapontlogistics.com)